

# HYATT PARK

## TOPOGRAPHIC SURVEY AND LANDSCAPE PLAN

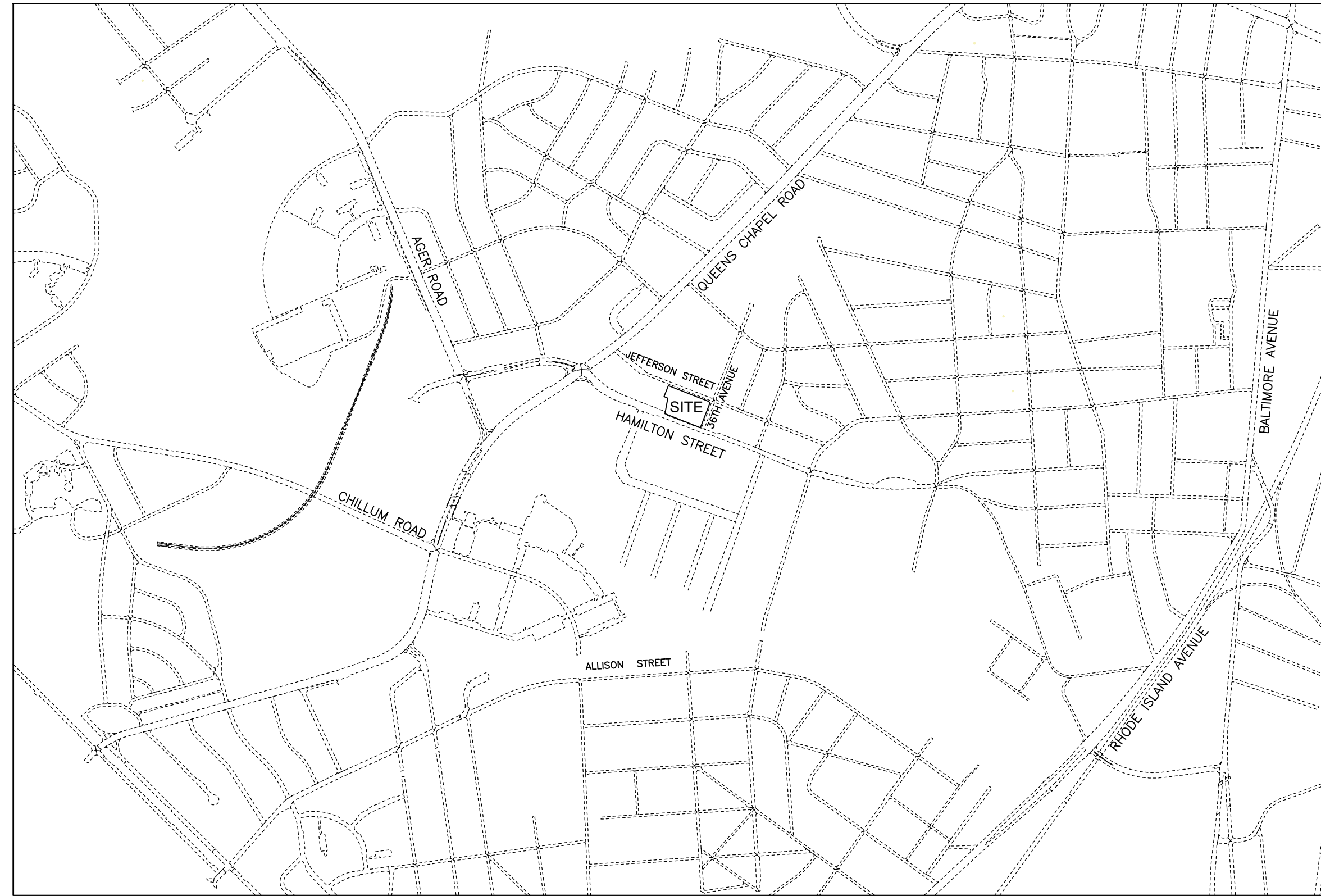

VICINITY MAP



### INDEX OF DRAWINGS

- SHEET 1 - TITLE SHEET
- SHEET 2 - TOPOGRAPHIC SURVEY
- SHEET 3 - LANDSCAPE DESIGN
- SHEET 4 - LANDSCAPE DETAILS

## HYATT PARK

TITLE SHEET

HAMILTON STREET PRINCE GEORGE'S COUNTY

**DEVELOPER:**  
CITY OF HYATTSVILLE  
4310 GALLATIN STREET  
HYATTSVILLE, MD 20781  
301-985-5000

**OWNER**  
THE MARYLAND NATIONAL CAPITAL PARK AND  
PLANNING COMMISSION  
6600 KENILWORTH AVE  
RIVERDALE, MD 20737

**DRAFT**  
NOT FOR  
CONSTRUCTION

BRADLEY SITE DESIGN, INC.  
LANDSCAPE ARCHITECTURE



159 Research Road  
Greenbelt, MD 20770  
P: 240.893.0626  
www.bradleysitedesign.com



WE PROTECT AND  
RESTORE WATERSHEDS  
www.mdsww.com

10944 Beaver Dam Rd. Suite C  
Hunt Valley, MD 21030  
p: 410.785.0875  
f: 443.269.0216

DATE	REVISION

Designed By:	Scale: 1" = 20'	Pr.No.: 20008.01&02
Drawn By:	Date: 03 06 2020	SHEET: 1 OF XX
Checked By:	Approved:	

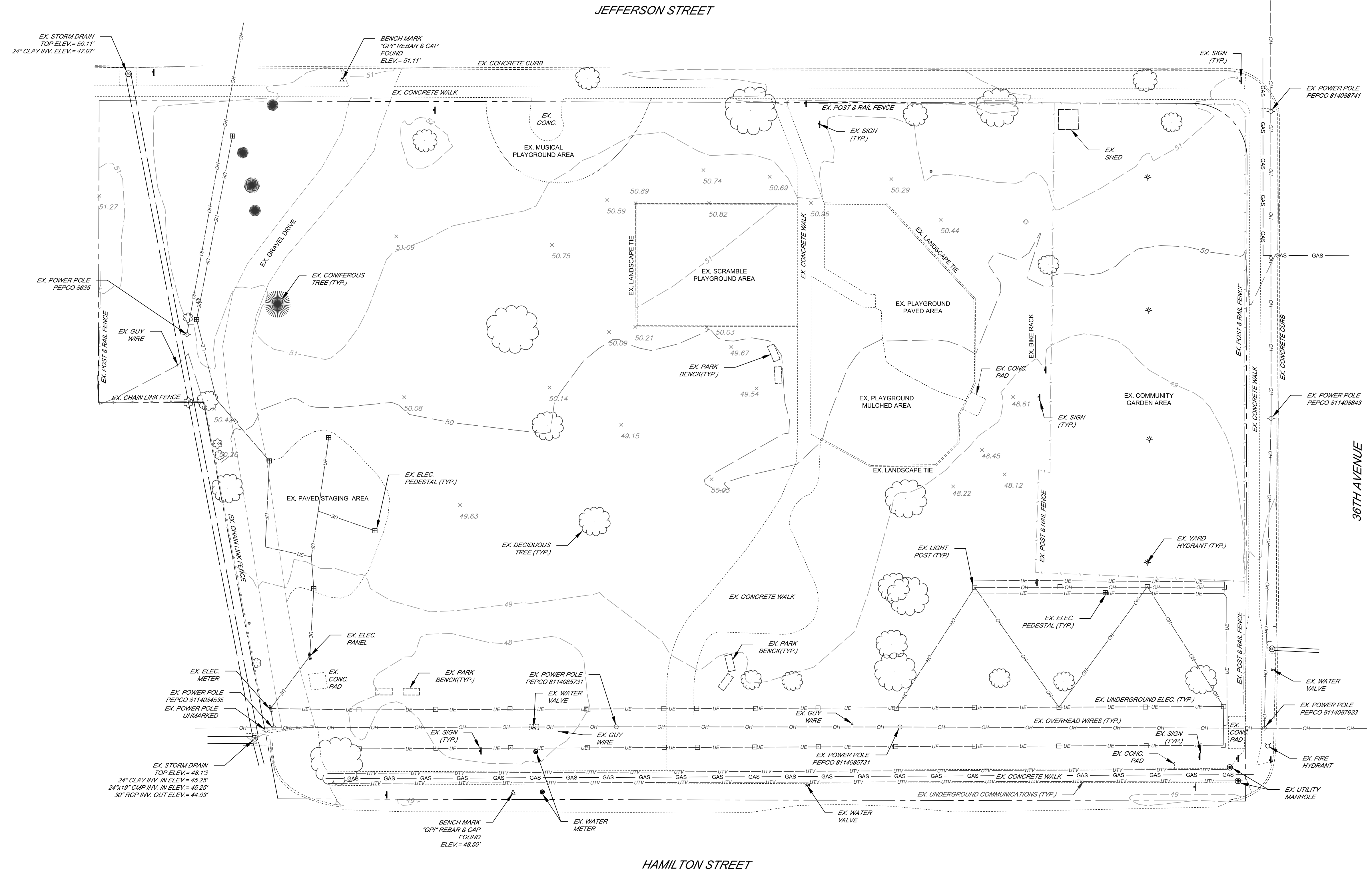
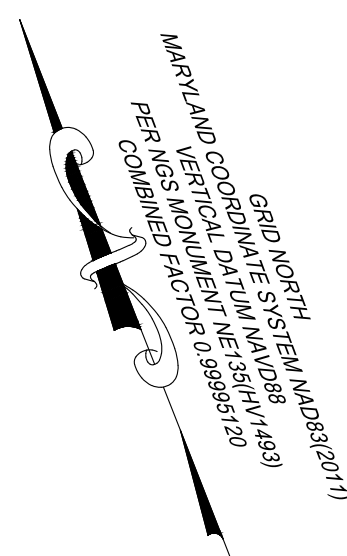

JOHN R. BEICHLER  
 PROFESSIONAL LAND SURVEYOR #21707  
 EXPIRES JUNE 4, 2021  
 I HEREBY CERTIFY THAT THIS SURVEY MADE ON THE GROUND UNDER MY DIRECT SUPERVISION MARCH 5TH, 2020 AND IS IN ACCORDANCE WITH THE REQUIREMENTS SET FORTH IN CHAPTER 6 REGULATION 0.12 OF THE MINIMUM STANDARDS OF PRACTICE FOR PROFESSIONAL LAND SURVEYORS IN THE STATE OF MARYLAND.

NOTE: THE BOUNDARY SHOWN HEREON WAS TAKEN FROM PLATS AND DEEDS OF RECORD AND DOES NOT REPRESENT A BOUNDARY SURVEY PERFORMED BY SMC

NOTE: THE UTILITIES SHOWN HEREON WERE TAKEN FROM MISS. UTILITY LOCATIONS AND THE "ELECTRIC NEW WORK POWER PLAN" PERFORMED BY JMT. OWNER/CONTRACTOR TO VERIFY ALL UTILITIES PRIOR TO CONSTRUCTION

**DRAFT**  
NOT FOR  
CONSTRUCTION

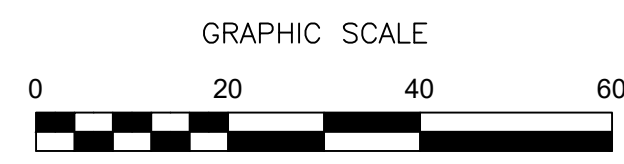

**SMC** 10944 Beaver Dam Rd. Suite C  
 Hunt Valley, MD 21030  
 WE PROTECT AND RESTORE WATERSHEDS  
 p: 410.785.0875  
 f: 443.269.0216  
 www.swmaintenance.com | www.mdswm.com

DATE	REVISION

**HYATT PARK**  
 TOPOGRAPHIC SURVEY  
 HAMILTON STREET PRINCE GEORGE'S COUNTY

Designed By: JRB	Scale: 1" = 20'	Pr.No.: 20008.01&02
Drawn By: JRB	Date: 03 06 2020	SHEET: 2 OF XX
Checked By: TS	Approved:	



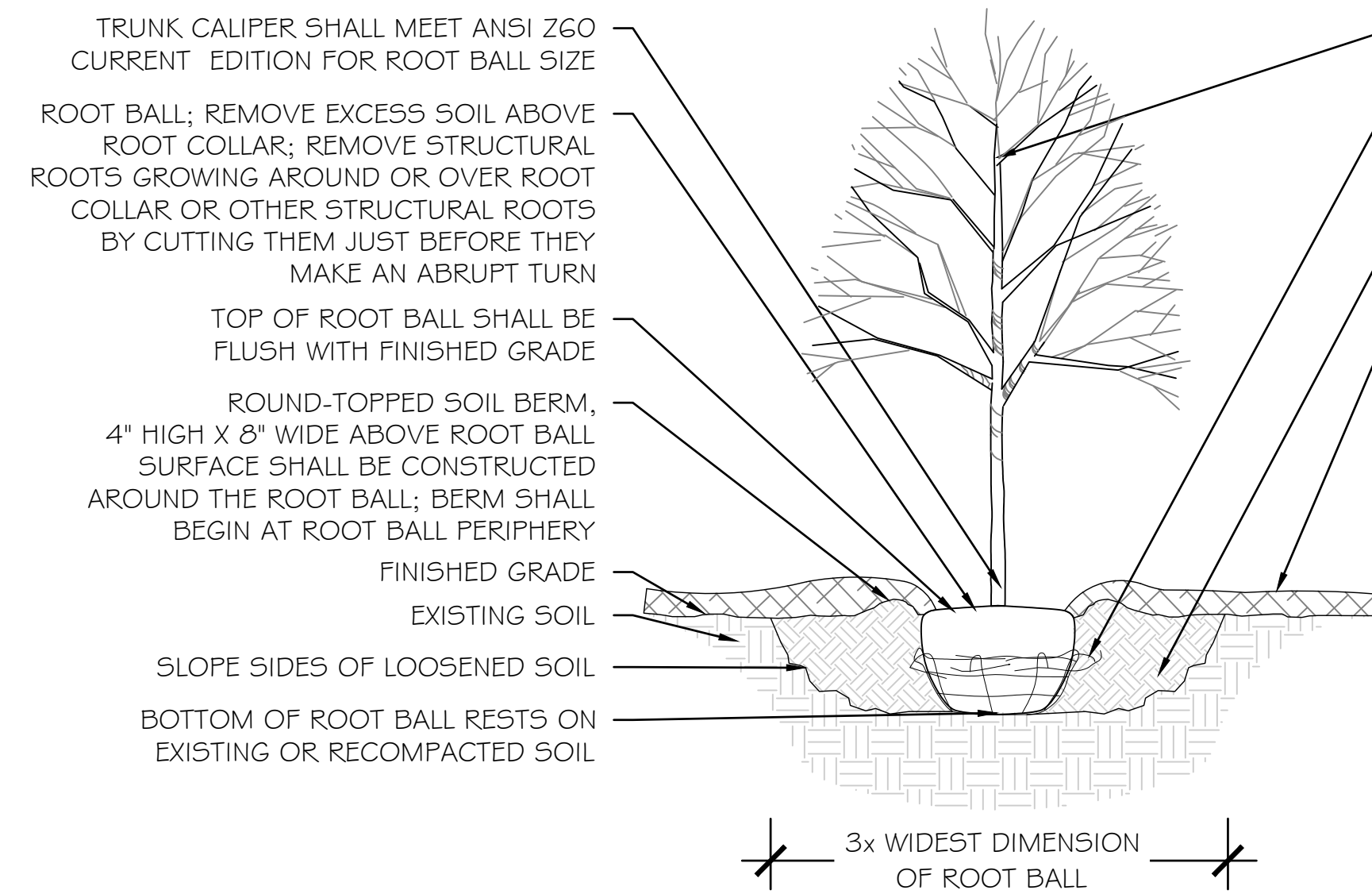

CENTRAL LEADER

PRIOR TO MULCHING, LIGHTLY TAMP SOIL AROUND THE ROOT BALL IN 6" LIFTS TO BRACE TREE. DO NOT OVER COMPACT. WHEN THE PLANTING HOLE HAS BEEN BACKFILLED, POUR WATER AROUND THE ROOT BALL TO SETTLE THE SOIL.

PLANTING SOIL PREPARED PER PG COUNTY SPECIFICATIONS, TYP.

4" LAYER OF MULCH; NO MORE THAN 1" OF MULCH ON TOP OF ROOT BALL (SEE SPECIFICATIONS FOR MULCH)

NOTES:

- TREES SHALL BE OF QUALITY PRESCRIBED IN CROWN OBSERVATIONS AND ROOT OBSERVATIONS DETAILS AND SPECIFICATIONS.
- AFTER THE ROOT BALL HAS BEEN BACKFILLED, REMOVE ALL TWINE AND BURLAP FROM THE TOP OF THE ROOT BALL. CUT THE BURLAP AWAY; DO NOT FOLD DOWN ONTO THE PLANTING SOIL.
- IF THE PLANT IS SHIPPED WITH A WIRE BASKET THAT DOES NOT MEET THE REQUIREMENTS OF A "LOW RISE" BASKET, REMOVE THE TOP 6 - 8 INCHES OF THE BASKET WIRES JUST BEFORE THE FINAL BACKFILLING OF THE TREE.
- SEE PG COUNTY SPECIFICATIONS FOR FURTHER REQUIREMENTS RELATED TO THIS DETAIL.

**A** TREE PLANTING  
NOT TO SCALE

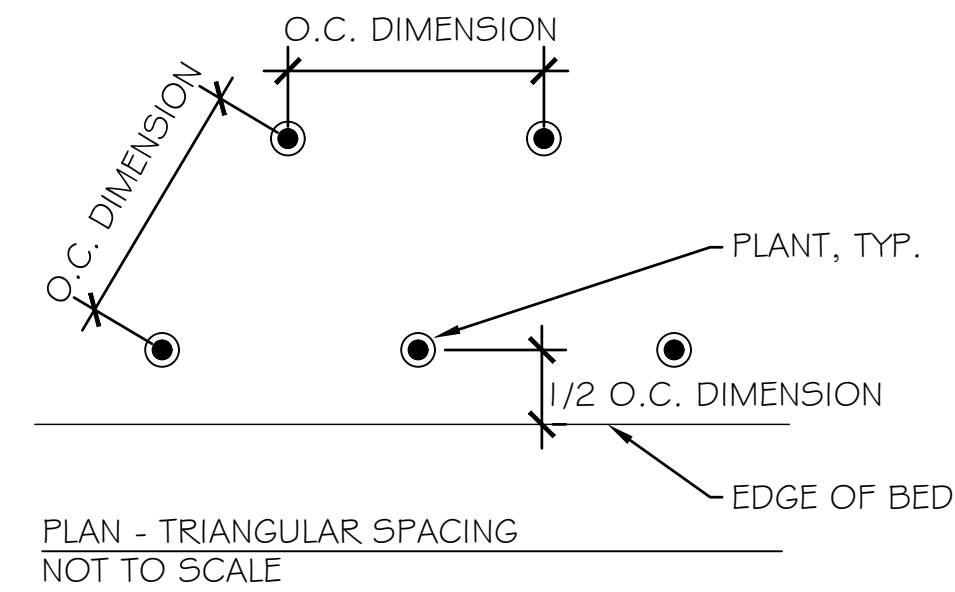
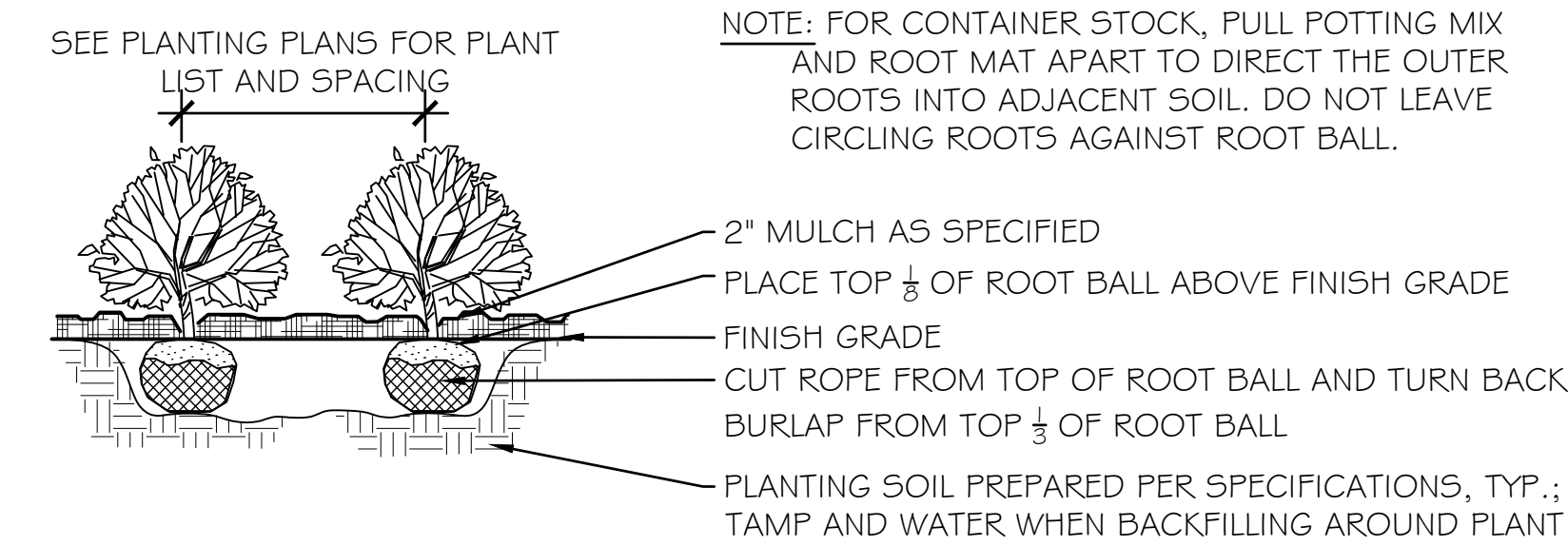

**B** SHRUB PLANTING  
NOT TO SCALE

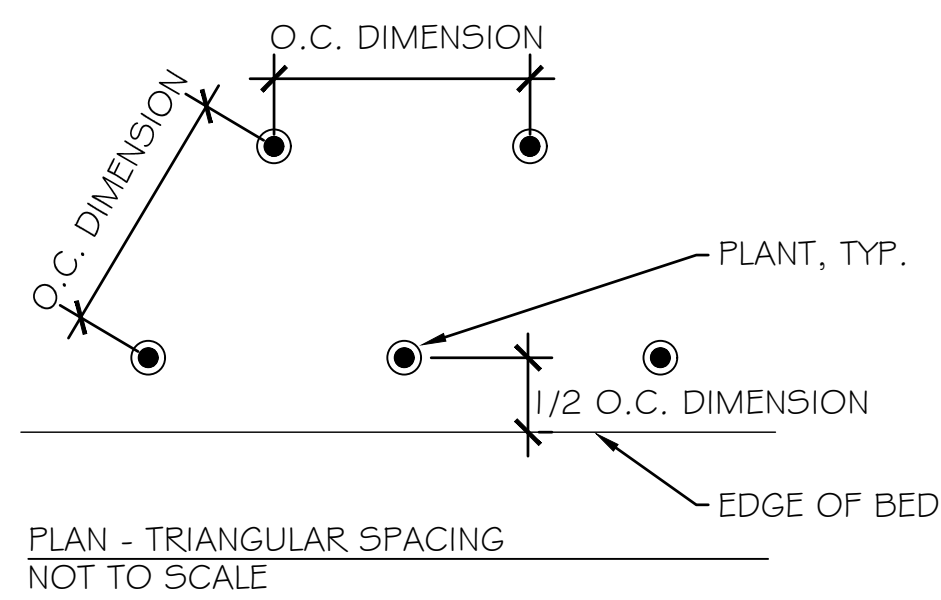
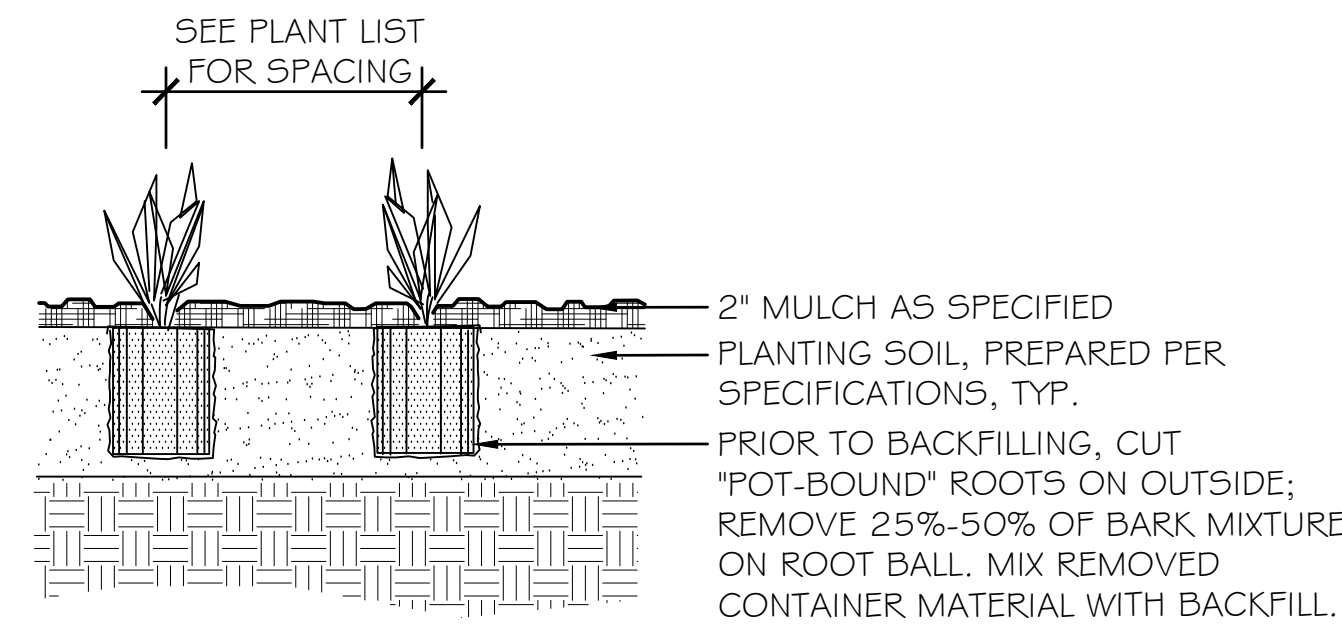

**C** PERENNIAL PLANTING  
NOT TO SCALE

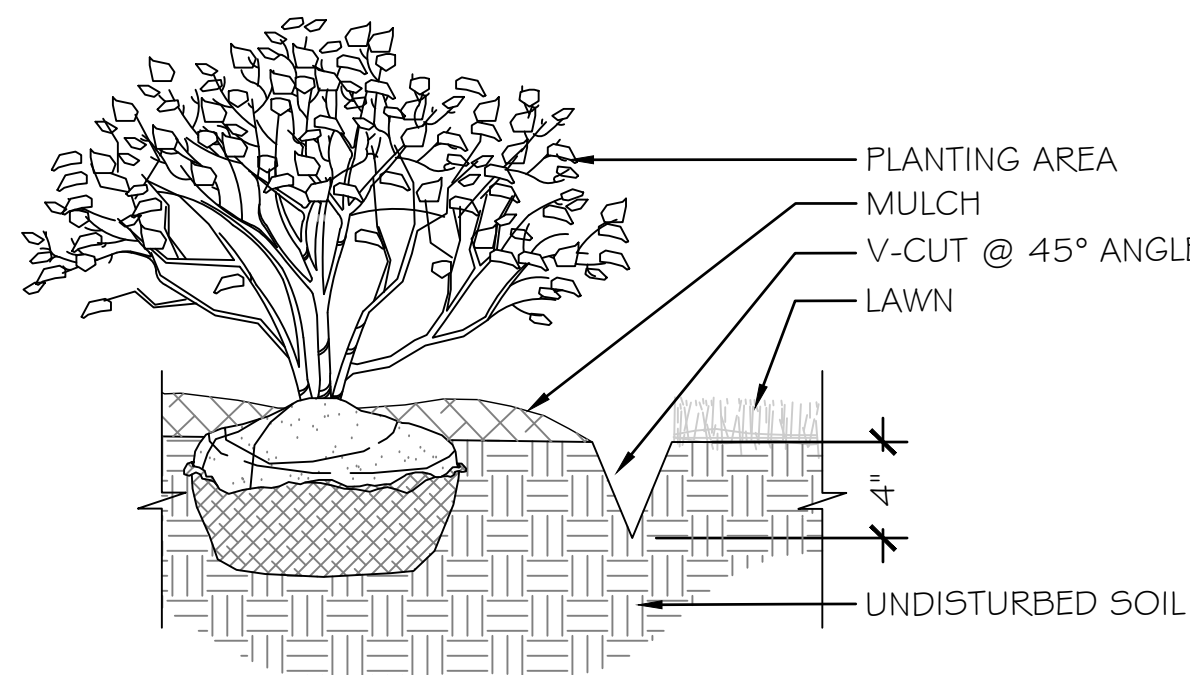

NOTE:

- PROVIDE PLANTING EDGE BETWEEN ALL PLANT BEDS AT TURF AREAS AND AT VEGETATED WATER QUALITY SWALES.

**D** LANDSCAPE EDGING  
NOT TO SCALE

PLANT SCHEDULE					
QTY.	BOTANICAL/COMMON NAME	SIZE	SPACING	REMARKS	NATIVE
<b>EVERGREEN TREES</b>					
17	MAGNOLIA GRANDIFLORA 'TMGH' Alta Southern Magnolia	10' ht.	As Shown	Specimen	YES
<b>SHRUBS</b>					
15	CALYCANTHUS FLORIDUS Carolina Allspice	36" ht. mn.	6' O.C.		YES
45	CLETHRA ALNIFOLIA 'RUBY SPICE' Ruby Spice Summersweet	24-36" ht.	48" O.C.		YES
60	CORNUS SANGUINEA 'CATO' Bloodtwig Dogwood	36" ht.	36" O.C.		NO
70	FOTHERGILLA 'JANE PLATT' Jane Platt Fothergilla	36" ht.	36" O.C.		YES
34	JUNIPERUS VIRGINIANA 'GREY OWL' Grey Owl Juniper	24" ht.	48" O.C.		YES
45	ROSA KNOCK-OUT 'RED' Red Knock-Out Rose	24-36" ht.	36" O.C.		NO
22	VIBURNUM RHYTIDOPHYLLUM Leatherleaf Viburnum	36" ht.	72" O.C.		NO
<b>PERENNIALS, ORNAMENTAL GRASSES, FERNS, VINES &amp; GROUNDCOVERS</b>					
65	LAVANDULA ANGUSTIFOLIA English Lavender	1 gal.	18" O.C.		NO
65	LIATRIS SPICATA Dense Blazing Star	1 gal.	18" O.C.		YES
125	MONARDA DIDYMA 'CORAL REEF' Coral Reef Bee Balm	1 gal.	24" O.C.		YES
75	MUHLENBERGIA CAPILLARIS Pink Muhly Grass	1 gal.	36" O.C.		YES
530	SALVIA x SYLVESTRIS 'MAINACHT' May Night Wood Sage	1 gal.	12" O.C.		NO
295	SCHIZACHYRIUM SCOPARIUM 'THE BLUES' The Blues Little Bluestem	1 gal.	18" O.C.		YES
170	SOLIDAGO RUGOSA 'FIREWORKS' Fireworks Goldenrod	1 gal.	24" O.C.		YES

PLANTING NOTES:

- TILL AND PREPARE SOIL IN ENTIRE PLANTING BED ACCORDING TO PG COUNTY SPECIFICATIONS. HAVE SOIL SAMPLES FROM THE PREPARED BEDS TESTED TO ENSURE THAT THE CHEMICAL AND MECHANICAL PROPERTIES COMPLY WITH THE COUNTY SPECIFICATIONS. SUPPLY LANDSCAPE ARCHITECT WITH COPIES OF THE LAB REPORTS AND OBTAIN APPROVAL OF THE PREPARED SOIL FROM THE LANDSCAPE ARCHITECT PRIOR TO PLANTING.
- DO NOT DRIVE MACHINERY OVER PREPARED PLANTING BEDS, OR OTHERWISE COMPACT THE SOIL AFTER PREPARATION.
- PLANT MATERIAL SUBSTITUTIONS MUST BE APPROVED BY THE LANDSCAPE ARCHITECT BEFORE THE PLANTS ARE BROUGHT TO THE SITE.
- PROTECTIVE FENCING SHALL BE ERECTED AT THE DRIPLINE OF THE EXISTING TREES BEFORE ANY CONSTRUCTION BEGINS, AND SHALL REMAIN IN PLACE UNTIL ALL CONSTRUCTION IS COMPLETE.
- MINIMIZE GRADING AND CONSTRUCTION OPERATIONS AS MUCH AS POSSIBLE IN THE ROOT ZONES OF EXISTING TREES TO REMAIN. CIVIL ENGINEER AND LANDSCAPE ARCHITECT TO APPROVE ALL GRADING, CONSTRUCTION, TRENCHING AND OTHER DISTURBANCE REQUIRED WITHIN THE ROOT ZONES OF THE TREES. DO NOT SHRED OR TEAR TREE ROOTS WITH EXCAVATION EQUIPMENT; CLEAN CUT ALL ROOT LARGER THAN 1-INCH WITH SAW OR CLIPPERS.
- DO NOT STOCKPILE SOIL OR CONSTRUCTION MATERIALS, OR DRIVE VEHICLES WITHIN DRIPLINE OF EXISTING TREES TO REMAIN.
- ALL PROPOSED LAWN AREAS AND DISTURBED EXISTING LAWN AREAS ARE TO BE SEEDED UPON COMPLETION OF CONSTRUCTION.
- IF DISCREPANCIES BETWEEN THE PLANTING PLAN AND PLANT LIST OCCUR, THE PLANTING PLAN TAKES PRECEDENCE.
- ALL SLOPE AREAS GREATER THAN 30% MUST BE STABILIZED WITH EROSION CONTROL FABRIC BEFORE PLANTING. SLOPE AREAS THAT WILL NOT BE PLANTED MUST BE SODDED PER CIVIL'S SPECIFICATIONS.

**HYATT PARK**  
LANDSCAPE DETAILS

HAMILTON STREET      PRINCE GEORGE'S COUNTY

**DRAFT**  
NOT FOR  
CONSTRUCTION

BRADLEY SITE DESIGN, INC.  
LANDSCAPE ARCHITECTURE

159 Research Road  
Greenbelt, MD 20770  
P: 240.893.0626  
www.bradleysitedesign.com

**SMC**  
WE PROTECT AND  
RESTORE WATERSHEDS

10944 Beaver Dam Rd. Suite C  
Hunt Valley, MD 21030  
p: 410.785.0875  
f: 443.269.0216  
www.swmaintenance.com | www.mdsww.com

DATE	REVISION

Designed By:	Scale: 1" = 20'	Pr.No.: 20008.01&02
Drawn By:	Date: 03 06 2020	SHEET: 4 OF XX
Checked By:	Approved:	

FILE PATH: W:\CAD\Projects\2008\0808\01\_8\_HYATT PARK SURVEY & LANDSCAPE DESIGN\Source - Data\2008\_03\_17\RECEIVED\Hyatt Park Landscape Arch BSD plans - detail\Hyatt Park Topographic Survey SMC 2008.01.ctb; LAST SAVED: 3/17/2009 3:50 PM BY: JRB